

**BHARTIYA**

**TUBE TOOLS**

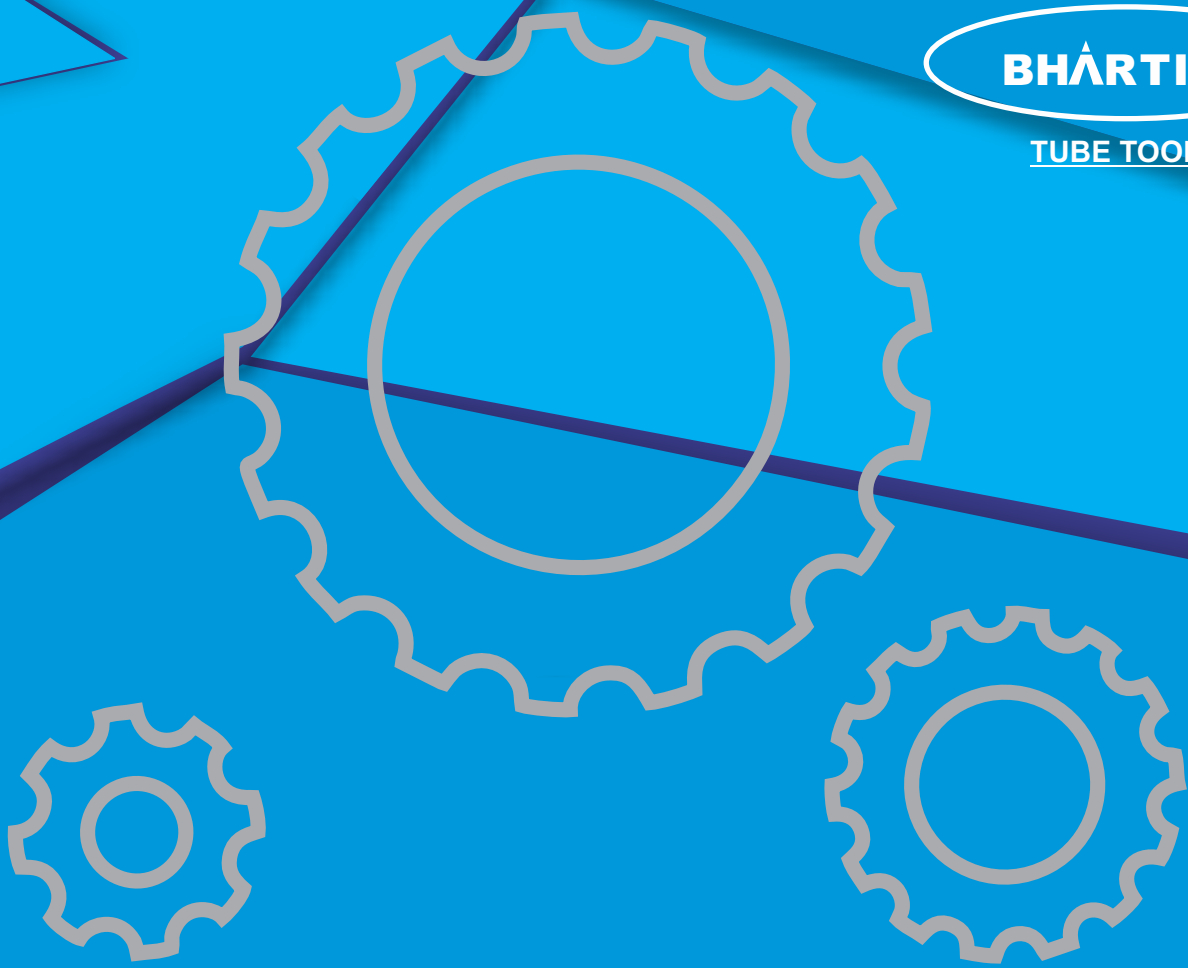

## **SQUARE DRIVE HYDRAULIC TORQUE WRENCH**



**SHINGARE**  
INDUSTRIES PVT LTD

# SQUARE DRIVE HYDRAULIC TORQUE WRENCH



Ideal for long-term usage by means of aluminum-titanium design. Besides having calibration service and support SHINGARE is one of the important brands that can accomplish big missions even its small body. Almost every tightening & loosening problems can be accomplished with these series that have a torque capacity up to 48666 Nm. SHINGARE serves a wide range accessory for SSD series. These products which are designed for serving true resolutions, entitled with TUV seal result of an effort with appropriate directives.

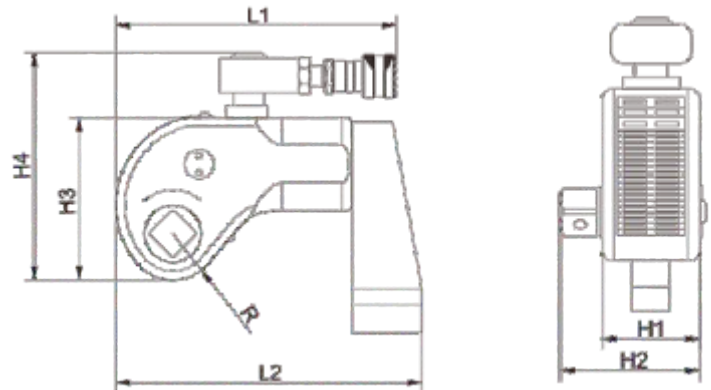

## SELECTION CHART

Model	Torque (N.M)	Bolt Size (M)	Square Drive Inches	Weight (kg)	Size						
					L1	L2	H1	H2	H3	H4	R
SSD-1A	172-1727	16-36	3/4"	2	129	167	51	73	90	131	25
SSD-3A	452-4529	22-48	1"	4.6	167	218	68	98	121	170	34
SSD-8A	1006-10064	30-64	1-1/2"	10	223	293	92	135	163	211	46
SSD-10A	1497-14974	36-72	1-1/2"	14.8	264	323	100	141	177	225	50
SSD-25A	3699-36992	48-100	2-1/2"	32.5	329	432	137	104	240	288	65
SSD-35A	4866-48666	64~120	2-1/2"	50	372.5	496.5	153	216	282	332	243.5

## ACCESSORIES

For Special Reaction Arm, consult to SIPL!

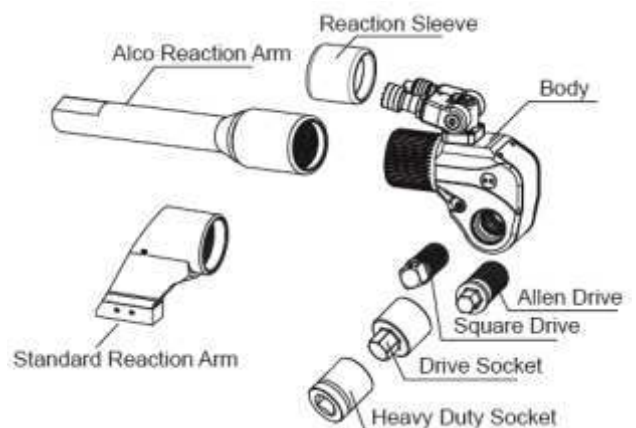

## FEATURES:

- Compact, lightweight aluminium body construction
- Output torque capacities from 183 to 34725 Nm
- Choice of square drive sizes from 3/4" to 2 1/2"
- Reversible square drive for tightening or loosening applications
- Multi-position reaction arm with safety lock feature
- Fitted with 360° uni-swivel quick release couplings for easy positioning
- The 360°×180° degree swivel is free to operation with no space limitation.
- Optional Allen hex drives available from 1/2" to 2 1/4" and 14 to 60 mm
- The new locking coupler ensures the oil keep free access.



PART	BSD-1	BSD-3	BSD-5	BSD-8	BSD-10	BSD-20	BSD-25
Torque (NM)	183-1837	451-4512	752-7528	1078-10780	1551-15516	2666-26664	3472-34725
Bolt Size A/F of Nut in mm	16-36	22-48	27-56	30-64	36-72	42-90	48-100
Weight (Kg)	2.5	5	10	11	15	26.5	35
Square Drive	3/4"	1"	1-1/2"	1-1/2"	1-1/2"	2-1/2"	2-1/2"

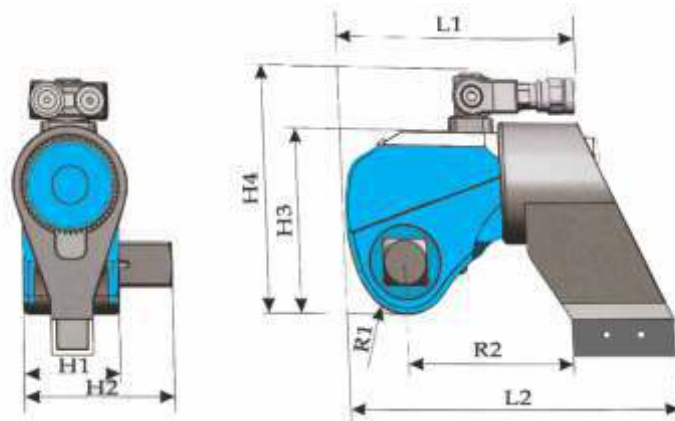

Model No. Dimension	BSD-1	BSD-3	BSD-5	BSD-8	BSD-10	BSD-20	BSD-25	BSD-35
L1	144.5	178	210.5	222	245.5	307.5	323	372.5
L2	173	229	270.5	293	317.5	383.5	401	496.5
H1	50	68	80	90	100	120	137	153
H2	72	95	123	134	142	183	200	216
H3	96	127	149	167	182	220	247	282
H4	131	176.5	199	217	232	270	297	332
R	91.5	123.5	140	165	178	213	228	243.5
R1	26	34	39	47	51	59	66	77
R2	85	114	137	153	154	186	199	214
R3	29	40	46.5	47	58.5	71	72.5	89.5

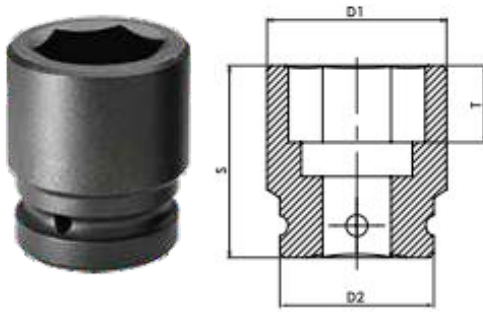

6 POINTS  
IMPACT SOCKETS

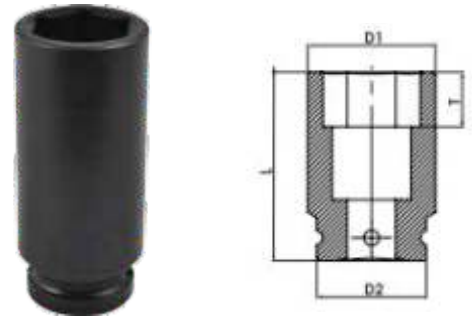

Model No.	Square Drive	Nut A/F		D1	D2	S	T	L
		inch	mm					
S-12M24	3/4"	-	24	40	44	46	21	90
S-12M27	3/4"	-	27	41	44	48	23	90
S-1217	3/4"	1.1/16	-	41	44	48	23	90
S-1230	3/4"	-	30	44	44	52	24	90
S-1220	3/4"	1.1/4	-	49	44	52	24	90
S-12M32	3/4"	-	32	49	44	52	26	90
S-12M36	3/4"	-	36	52	44	55	28	90
S-1223	3/4"	1.7/16	-	52	44	56	28	90
S-12M41	3/4"	-	41	57	44	59	36	90
S-1226	3/4"	1.5/8	-	57	44	59	36	90
S-12M46	3/4"	-	46	67	44	64	37	90
S-1229	3/4"	1.13/16	-	67	44	64	36	90
S-12M50	3/4"	-	50	70	54	67	39	90
S-1232	3/4"	2	-	73	54	67	39	90
12M55DH	3/4"	-	55	78	54	71	41	94
S-1635	3/4"	2.3/16	-	78	54	71	41	94
12M60DH	3/4"	-	60	82	52	75	45	98
S-1638	3/4"	2.3/8	-	82	54	75	45	98
S-12M24	1"	-	24	42	54	55	21	100
S-12M27	1"	-	27	46	54	55	23	100
S-1217	1"	1.1/16	-	46	54	55	23	100
S-12M30	1"	-	30	50	54	57	24	100
S-1220	1"	1.1/4	-	51	54	57	24	100
S-12M32	1"	-	32	51	54	57	26	100
S-12M36	1"	-	36	54	54	60	28	100
S-1223	1"	1.7/16	-	54	54	60	28	100
S-12M41	1"	-	41	63	54	64	36	100
S-1226	1"	1.5/8	-	63	54	64	36	100
S-12M46	1"	-	46	70	54	69	36	100
S-1229	1"	1.13/16	-	70	54	69	36	100
S-1250	1"	-	50	73	54	72	36	100
S-1232	1"	2	-	73	54	72	39	100
12M55DH	1"	-	55	82	54	76	41	105
S-1635	1"	2.3/16	-	82	54	80	41	105
12M60DH	1"	-	60	86	54	82	45	112
S-1638	1"	2.3/8	-	88	54	85	45	112
S-16M65	1"	-	65	92	54	85	46	118
S-1641	1"	2.9/16	-	92	54	85	46	118
S-16M70	1"	-	70	96	54	88	50	124
S-1644	1"	2.3/4	-	96	54	88	50	124
S-16M75	1"	-	75	100	86	92	57	124
S-1647	1"	2.15/16	-	100	86	92	57	124
S-16M100	1"	-	100	135	86	112	62	143
S-1650	1"	3.1/8"	-	105	86	97	57	132
S-16M80	1"	-	80	105	86	97	62	132
S-16M85	1"	-	85	115	86	100	62	132
S-1656	1"	3.1/2"	-	121	86	104	62	140
S-16M90	1"	-	90	127	86	104	62	140
S-16M95	1"	-	95	135	86	106	62	140

Model No.	Square Drive	Nut A/F		D1	D2	S	T	L
		inch	mm					
S-1662	1"	3.7/8"	-	135	86	112	62	143
S-16M36	1.1/2"	-	36	64	86	80	28	130
S-16M41	1.1/2"	-	41	69	86	83	32	130
S-16M46	1.1/2"	-	46	76	86	86	36	130
S-1629	1.1/2"	1.13/16	-	76	86	86	36	130
S-12M50	1.1/2"	-	50	81	86	90	39	130
S-1232	1.1/2"	2	-	81	86	90	39	130
12M55DH	1.1/2"	-	55	88	86	95	41	140
S-1635	1.1/2"	2.3/16	-	88	86	95	41	140
S-16M60	1.1/2"	-	60	96	86	98	45	140
S-1638	1.1/2"	2.3/8	-	96	86	98	45	140
S-16M65	1.1/2"	-	65	102	86	102	46	140
S-1641	1.1/2"	2.9/16	-	102	86	102	46	140
S-16M70	1.1/2"	-	70	108	86	102	50	150
S-1644	1.1/2"	2.3/4	-	108	86	102	50	150
S-16M75	1.1/2"	-	75	116	86	108	57	150
S-1647	1.1/2"	2.15/16	-	116	86	108	57	150
S-16M80	1.1/2"	-	80	120	86	110	62	150
S-1650	1.1/2"	3.1/8	-	120	86	110	62	150
S-16M85	1.1/2"	-	85	130	86	115	62	170
S-16M90	1.1/2"	-	90	135	125	118	65	170
S-1656	1.1/2"	3.1/2	-	135	125	118	65	170
S-16M95	1.1/2"	-	95	140	125	123	70	170
S-16M100	1.1/2"	-	100	148	125	128	75	190
S-1662	1.1/2"	3.7/8	-	148	125	128	75	190
S-16M105	1.1/2"	-	105	155	125	133	80	190
S-1668	1.1/2"	4.1/4	-	155	125	133	80	190
S-16M110	1.1/2"	-	110	161	150	138	85	200
S-16M115	1.1/2"	-	115	161	150	143	94	200
S-1670	1.1/2"	4.5/8	-	175	150	149	94	200
S-16M80	2.1/2"	-	80	135	125	140	62	190
S-1650	2.1/2"	3.1/8	-	135	125	140	62	190
16M85DH	2.1/2"	-	85	140	125	140	62	190
16M90DH	2.1/2"	-	90	145	125	140	65	190
16M95DH	2.1/2"	-	95	155	125	150	70	190
1662DH	2.1/2"	3.7/8	-	155	125	150	70	190
S-24M100	2.1/2"	-	100	160	125	150	75	200
S-24M105	2.1/2"	-	105	165	125	160	80	200
S-24M110	2.1/2"	-	110	174	150	160	85	210
S-24M115	2.1/2"	-	115	180	150	170	90	210
S-2472	2.1/2"	4.1/2	-	180	150	170	90	210
S-2480	2.1/2"	5	-	195	150	175	98	220
S-24M130	2.1/2"	-	130	195	150	175	98	220
S-2482	2.1/2"	5.3/8	-	205	150	180	102	220
S-40M145	2.1/2"	-	145	220	150	180	105	230
S-4092	2.1/2"	5.3/4	-	220	150	180	105	230
S-4098	2.1/2"	6.1/8	-	230	180	190	110	250
S-40104	2.1/2"	6.1/2	-	240	180	200	120	-
S-40110	2.1/2"	6.7/8	-	255	180	200	120	-

## REDUCERS

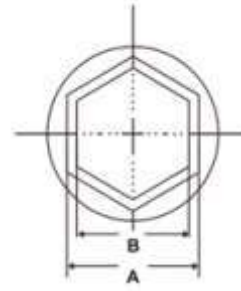

Wrench Model	Cassette	Nut Size (S)	Locking ring / Reducer		
SXD2				50/36	50/32
	SXD2-46	46	46/36	46/32	46/30
	SXD2-41	41	41/32	41/30	41/27
	SXD2-36	36	36/30	36/27	
	SXD2-32	32	32/27		
SXD4	SXD4-65	65	65/55	65/50	65/46
	SXD4-60	60	60/50	60/46	60/41
	SXD4-55	55	55/46	55/41	55/36
	SXD4-50	50	50/41	50/36	50/32
	SXD4-46	46	46/36	46/32	46/30
	SXD4-41	41	41/32	41/30	41/27
	SXD4-36	36	36/30	3/27	
	SXD4-32	32	32/27		
SXD8	SXD8-90	90	90/80	90/75	90/70
	SXD8-85	85	85/75	85/70	85/65
	SXD8-80	80	80/70	80/65	80/60
	SXD8-75	75	75/65	75/60	75/55
	SXD8-70	70	70/60	70/55	70/50
	SXD8-65	65	65/55	65/50	65/45
	SXD8-60	60	60/50	60/46	
	SXD8-55	55	55/46	55/41	
SXD14	SXD14-115	115	115/105	115/100	115/95
	SXD14-110	110	110/100	110/95	110/90
	SXD14-105	105	105/95	105/90	105/85
	SXD14-100	100	100/90	100/85	100/80
	SXD14-95	95	95/85	95/80	95/75
	SXD14-90	90	90/80	90/75	90/70
	SXD14-85	85	85/75	85/70	85/65
	SXD14-80	80	80/70	80/65	
	SXD14-75	75	75/65		
SXD32	SXD32-155	155	155/145	155/130	155/120
	SXD32-145	145	145/130	145/120	145/115
	SXD32-130	130	130/120	130/115	130/110
	SXD32-120	120	120/110	120/105	120/100
	SXD32-115	115	115/105	115/100	115/95
	SXD32-110	110	110/100	110/95	110/90
	SXD32-105	105	105/95	105/90	100/80
	SXD32-100	100	100/90	100/85	100/80
	SXD32-95	95	95/85	95/80	
	SXD32-90	90	90/80		
	SXD32-85	85			
	SXD32-80	80			

# OPEN SPANNER HYDRAULIC TORQUE WRENCH – BOSD SERIES

Open Spanner series is the professional special type hydraulic torque wrench which 'SHINGARE' vigorously extends in international market. Compare with the conventional cassette type hydraulic torque wrench, this series works directly on the nuts, fixed in cramped space and almost inaccessible area and its body suits well in the narrow space. Open Spanner series covers the nuts from S36 to S135 & Suitable for BOP, Christmas Tree, Well-Head Equipment, Valve Manifold, Limited Clearance Area.

## OPEN SPANNER ATTACHMENT

ROLLER TYPE SPECIAL TOOL DESIGN FOR APPLICATIONS.

## NEW ARRIVAL

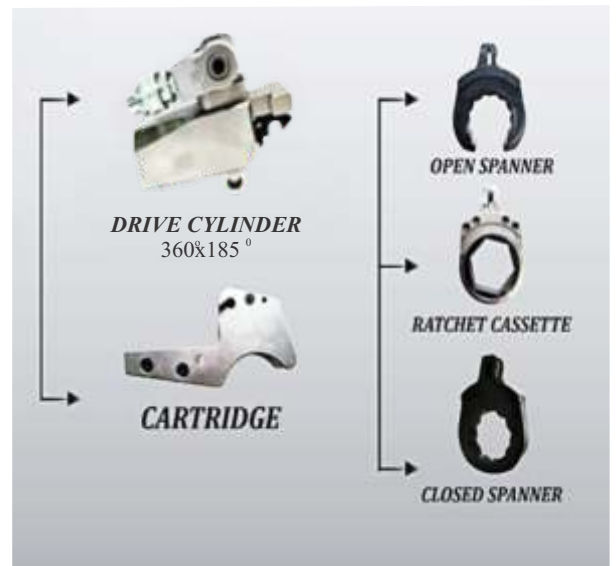
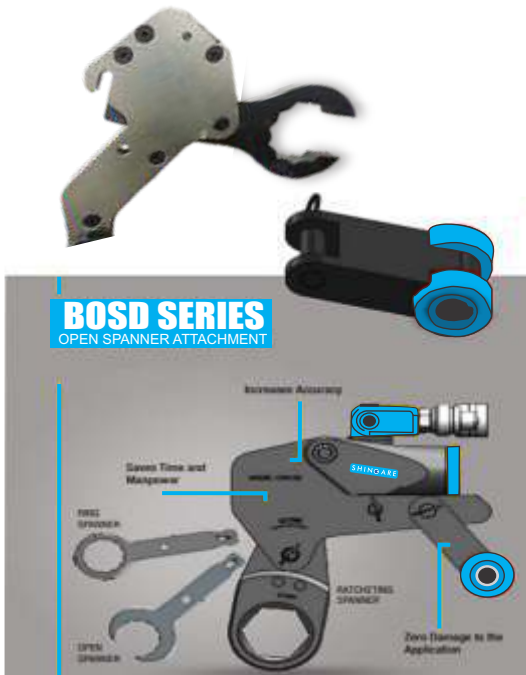

## SPECIFICATION

Torque Range:	241 – 41800 Nm
Available Spanner Size:	A/F -55 – 85 mm A/F - 1 7/16 – 5 3/8 inch

## SPANNER WRENCH DIMENSION

